



## OFFICE DESIGN IDEAS BOOK FOR:

- OFFICE SUITES
- WORKSTATIONS

## PHARMISTMP

14,400 SQ. FT.  
LAKE SUCCESS, NY



**cubicles.com**

we are so much more than cubicles

# 2D OVERALL PROPOSED FURNITURE LAYOUT -

- ┌ └ **OPEN AREA**
- ┌ └ **OFFICE SUITES:**
- ┌ └ **OPEN AREA COMUNAL TABLES:**
- ┌ └ **PRINT STATION AREA**

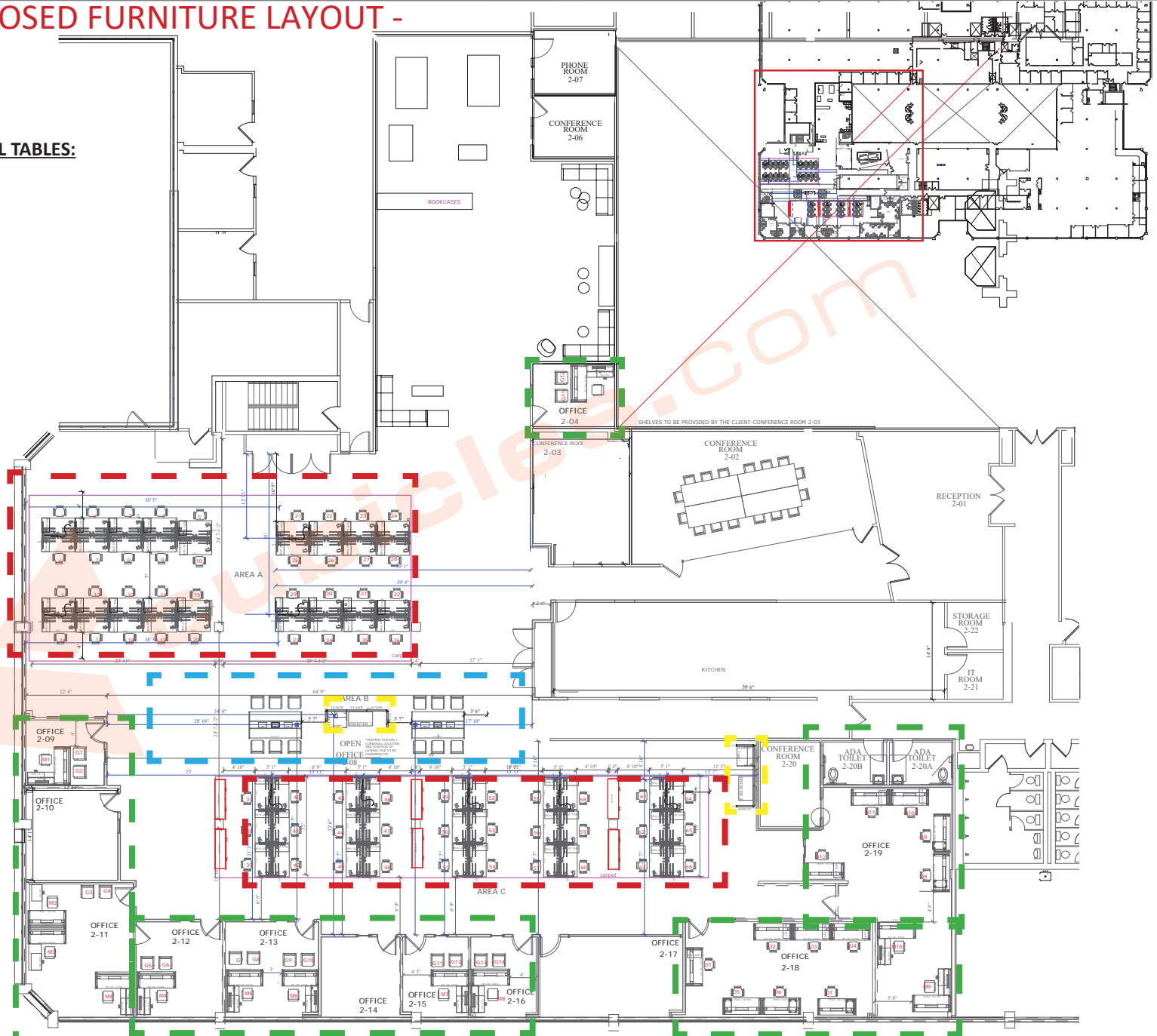

# 3D OVERALL PROPOSED FURNITURE LAYOUT -

OPEN AREA  
[66] 60"X29"D HEIGHT ADJUSTABLE STATIONS WITH MOBILE BOX/FILE PEDESTAL W/ CUSHION  
[6] STORAGE CREDENZAS: 72"Wx20"Dx29.5"H

[2] PRINTER STATIONS

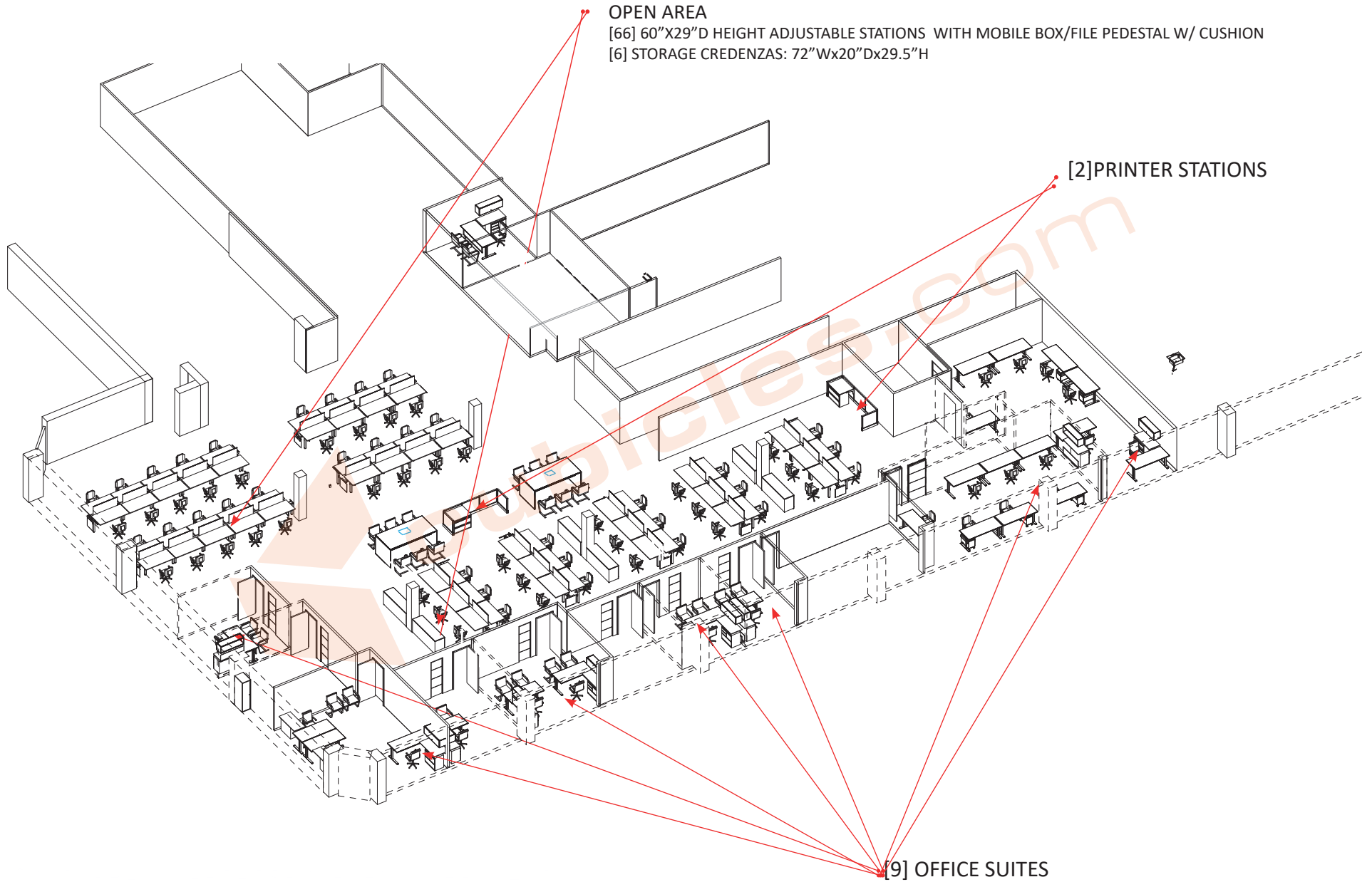

# OPEN AREA

## STATIONS - AMQ HEIGHT-ADJUSTABLE SYSTEM



### OPEN AREA

[66] 60"X29"D HEIGHT ADJUSTABLE STATIONS WITH MOBILE BOX/FILE PEDESTAL W/ CUSHION

---OPEN OFFICE - [5] x 6 WORKSTATIONS -60"x29" EACH

---OPEN OFFICE - [2] x 8 WORKSTATIONS -60"x29"-EACH

---OPEN OFFICE - [2] x 10 WORKSTATIONS - 60"x29"-EACH

[6] STORAGE CREDENZAS: 72"Wx20"Dx29.5"H

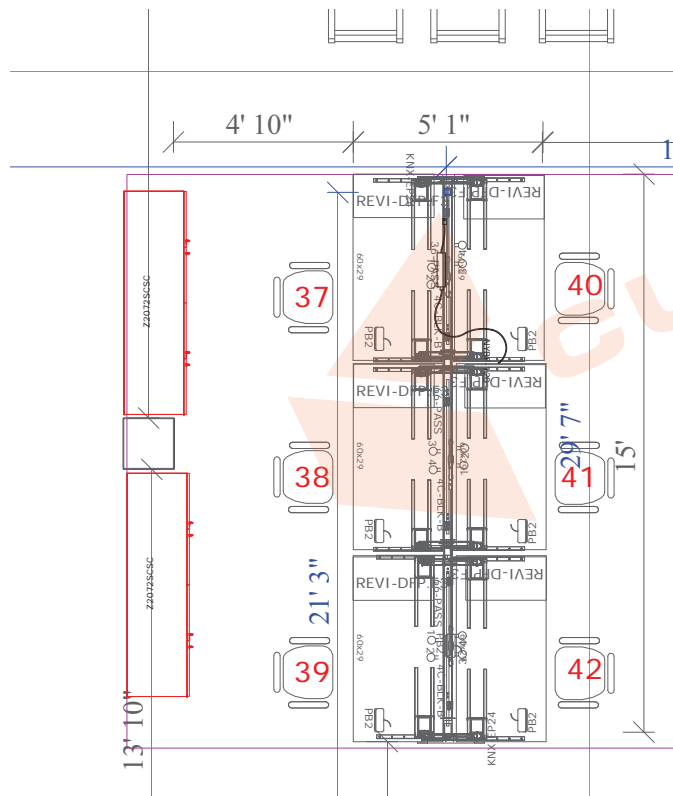

---TYP. OPEN OFFICE 6 WORKSTATIONS -60"Wx29"D X 29 1/2"/EA.

\*MOBILE BOX FILE PEDESTAL WITH CUSHION

3D CLUSTER

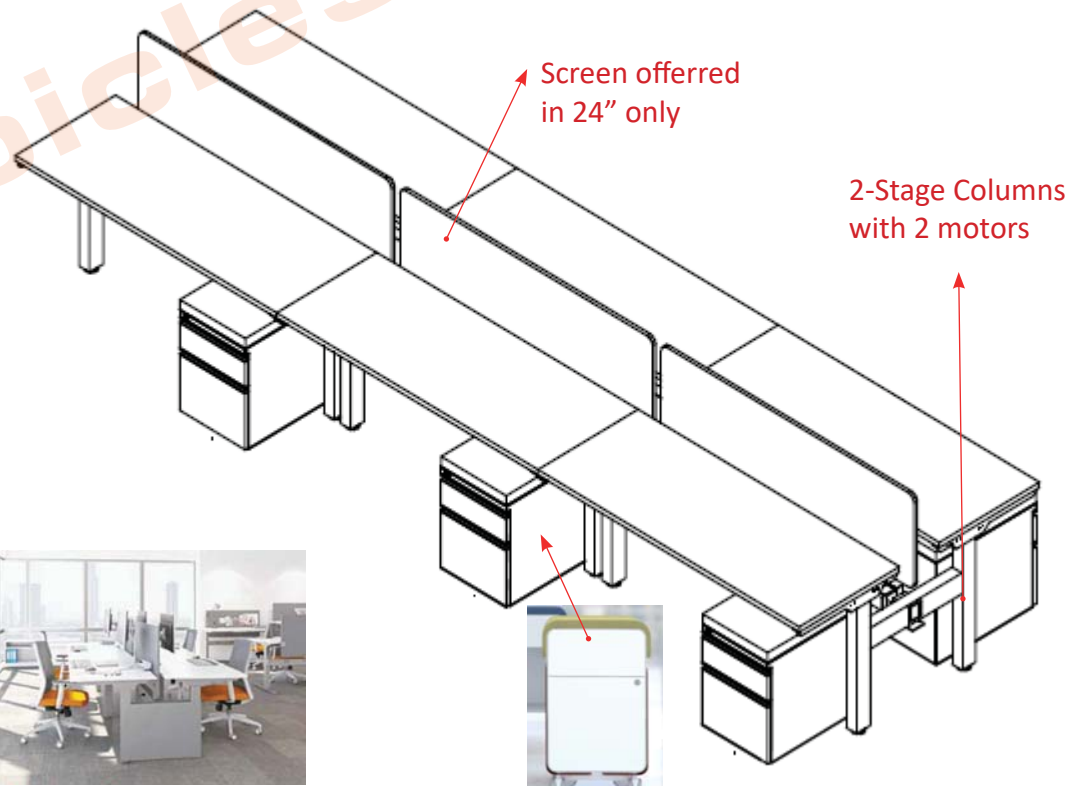

Screen offered in 24" only

2-Stage Columns with 2 motors

# OPEN AREA

STATIONS - j U ° HEIGHT-ADJUSTABLE SYSTEM



3F Screens 50"Wx24"H



# OPEN AREA

STATIONS - j U ° HEIGHT-ADJUSTABLE SYSTEM



# OPEN AREA

STATIONS - j U ° HEIGHT ADJUSTABLE SYSTEMS



FOR VISUAL PURPOSE ONLY.

STORAGE CREDENZAS:

COLLABORATIVE TABLE

# OFFICE SUITES QMA

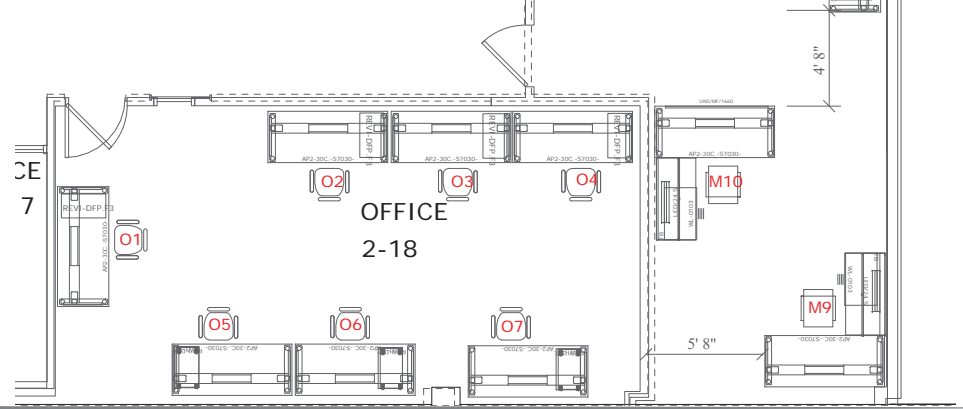
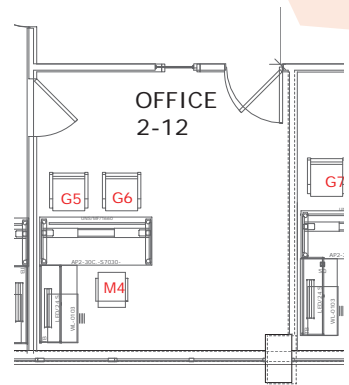
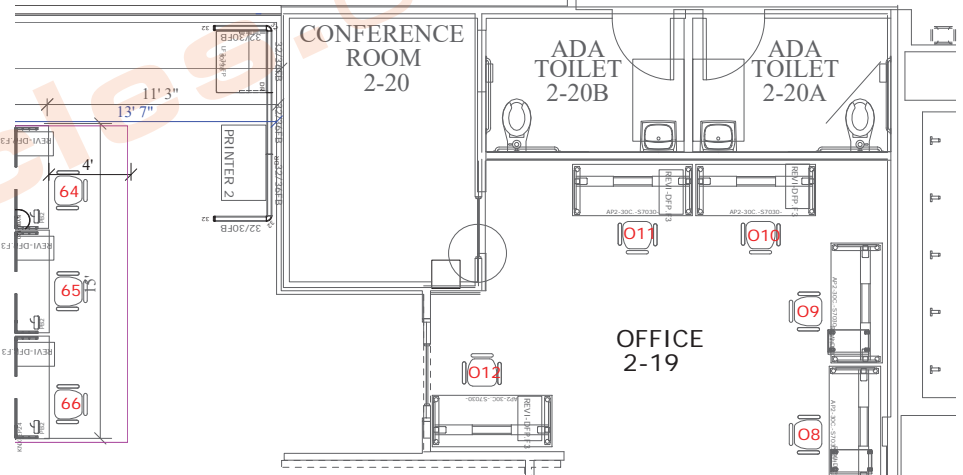
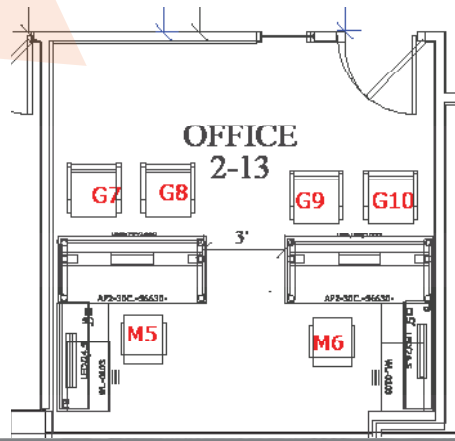
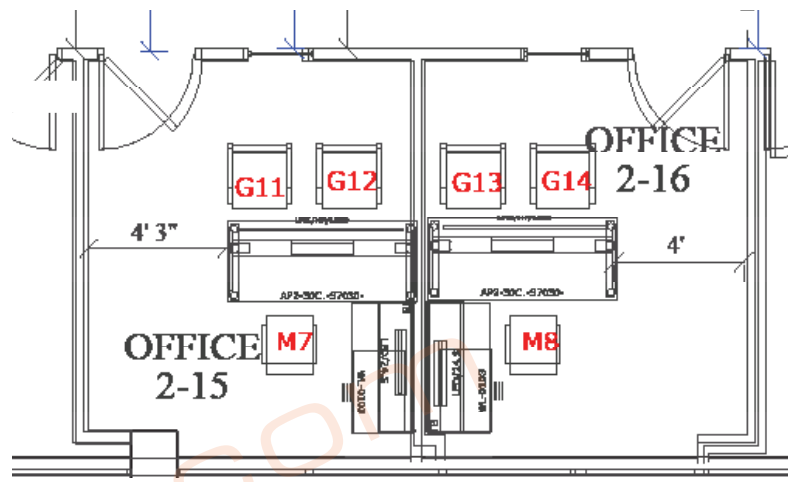
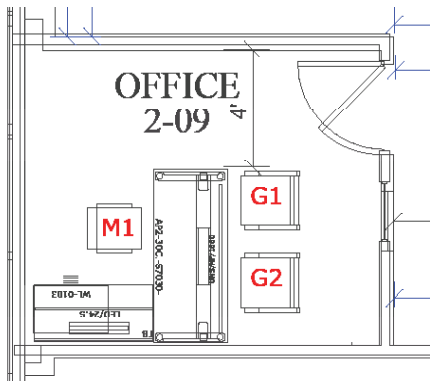

cubicles.com



# OFFICE SUITES

## OFFICE SUITES - STATIONS - j U ° HEIGHT ADJUSTABLE SYSTEMS

OFFICE SUITES 2-09; 2-11; 2-12; 2-13; 2-15; 2-16; 2-18; 2-19; 2-04

### L-SHAPE DESKS

[12] L-SHAPE DESKS:

---[10] 70"x30" HEIGHT ADJUSTABLE TOP & 48"Wx23"D SIDE WORKSURFACE

---[2] 66"x30" HEIGHT ADJUSTABLE TOP & 48"Wx23"D SIDE WORKSURFACE

### ACCESSORIES

--- [12] STORAGE COMBO UNITS

--- [10] OVERHEAD STORAGE UNITS WITH TASK LIGHTS

--- [10] TACKBOARDS

--- [11] MODESTY PANELS

[12] STRAIGHT DESKS WITH MOBILE BOX/BOX/FILE PEDESTALS

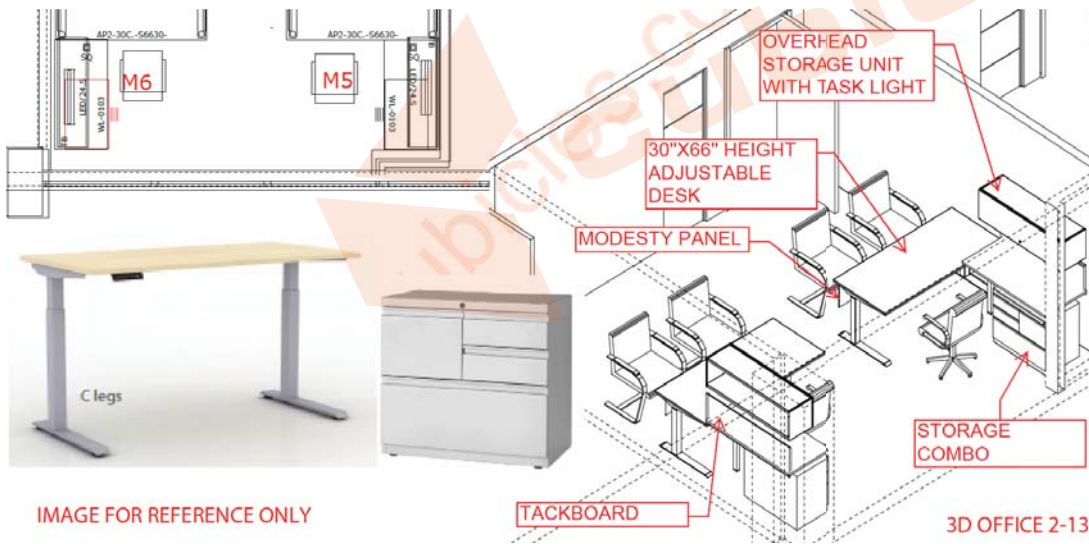
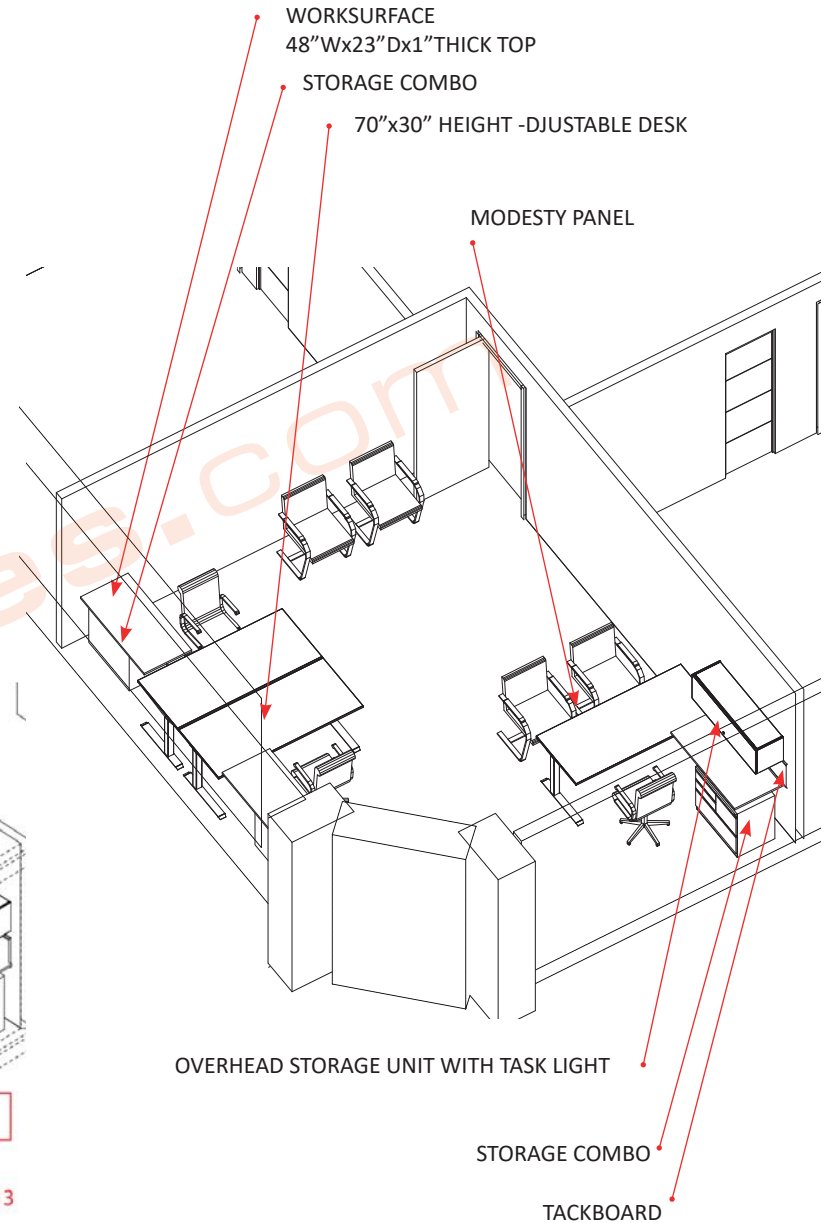

IMAGE FOR REFERENCE ONLY



# OFFICE SUITES



## OFFICE SUITES - QMA HEIGHT-ADJUSTABLE SYSTEM

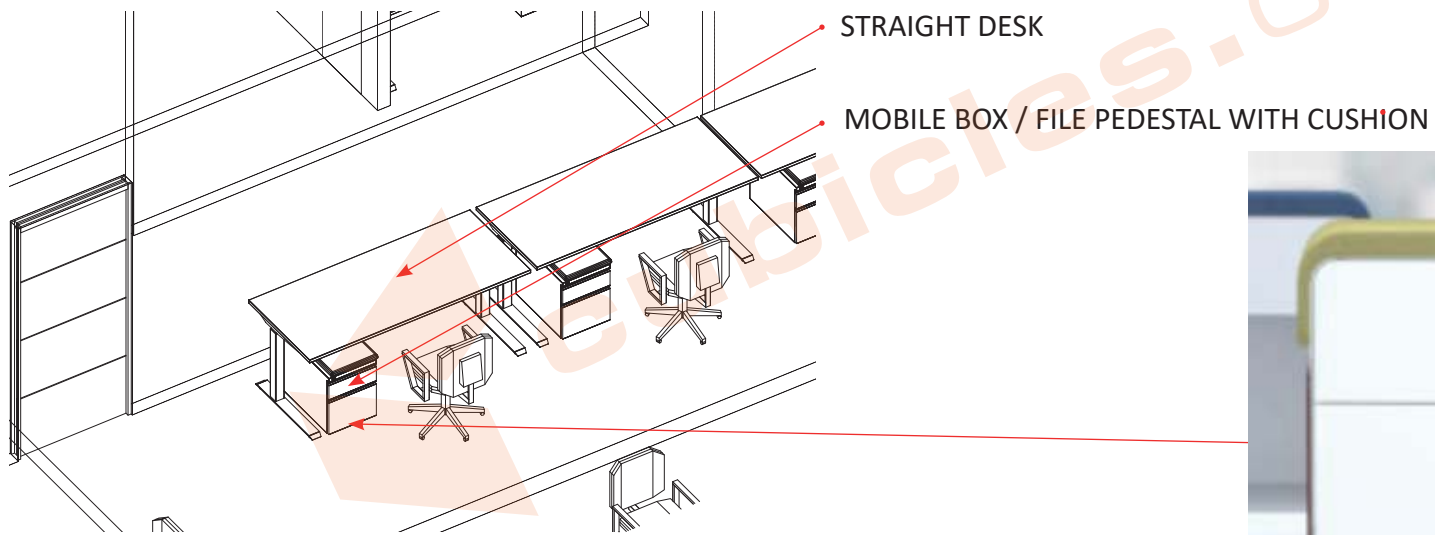

# OFFICE SUITES - OFFICE 13



## OFFICE SUITES -QMA HEIGHT-ADJUSTABLE SYSTEM



## OFFICE SUITES - STORAGE COMBO & OVERHEAD STORAGE



WALL-MOUNTED OVERHEAD STORAGE

WALL MOUNTED TACKBOARD

RETURN IS NOT HEIGHT ADJUSTABLE

COMBO STORAGE

MAIN DESK IS HEIGHT ADJUSTABLE

\*FABRIC MODESTY PANEL

**CUBICLES.COM** is a nationwide leader in the world of office furniture and furniture services. We've spent the last 20+ years building and maintaining a vast network of manufacturers, designers, contractors and facilities allowing us to cater to the commercial office, the home office, and everything in between.

### CONTRACT OFFICE FURNISHINGS

Our full-service agency provides a dedicated hands-on team of professional designers, specifiers and project managers to deliver your commercial office project from a conceptual dream to a "ready to move in" reality. We are committed to providing every client with quality products, fair pricing, and efficient service.

### PRODUCTS INCLUDE:

Cubicles \* Desks \* Tables \* Reception \* Conference \* Seating  
Filing & Storage \* Lounge \* Breakroom \* Sit Stand \* Acoustic Tiles  
Modular Walls \* Glass Walls \* Office Carpeting \* Home Living  
And more!

### SERVICES INCLUDE:

Sales & Rentals (New & Used) \* Space Planning & Design  
Budgeting & Financing \* Project Management \* Installation &  
Logistics \* Moving & Warehousing \* Inventory Management

### WE PROUDLY SERVE:

Corporate \* Residential \* Government/GSA \* Healthcare \* Education



WE SERVE ALL AGENCIES, ALL ACROSS AMERICA



**Honeywell**



**SIEMENS**



REFERENCES AVAILABLE UPON REQUEST



see more at [cubicles.com/reviews](https://cubicles.com/reviews)